

FOR LEASE

235 E.

1600 South

PROVO UT

BUILDING 7

TIMPANOGOS TECHNOLOGY CENTER

- Warehouse 21,020 SF
Suite 100 - \$0.60 NNN
- Office 13,795 SF
Suite 110 - \$19.50 FS
- Total SF Available - 34,815 SF



Accelerating success.



- 495,628 SF sprawling on 30 acres
- Soccer, volleyball, basketball facilities
- Full access gym for all tenants
- Beautiful grass area and walking paths
- Provo Towne Center Mall minutes away
- Shuttle service - multiple Provo stops
- Close to revitalized Downtown Provo
- Parking ratio 5/1000
- Back-up generators for all buildings
- On-site property management
- 24-hour security
- Quick access to I-15

FLOOR PLAN

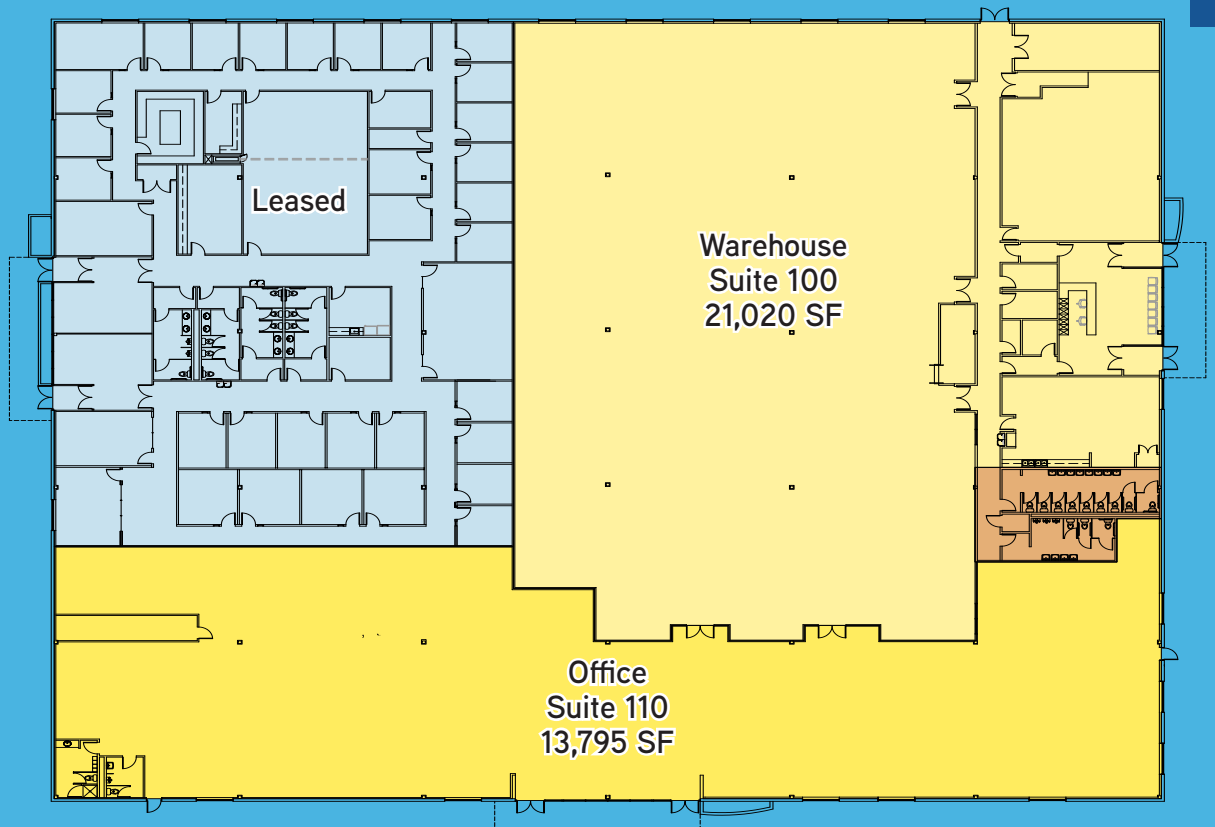

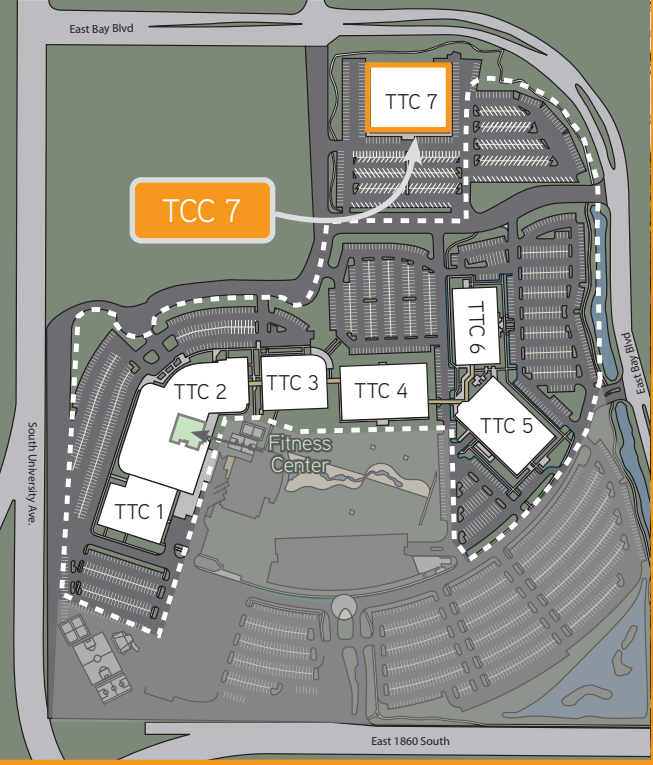

235 E.

1600 South



Interior

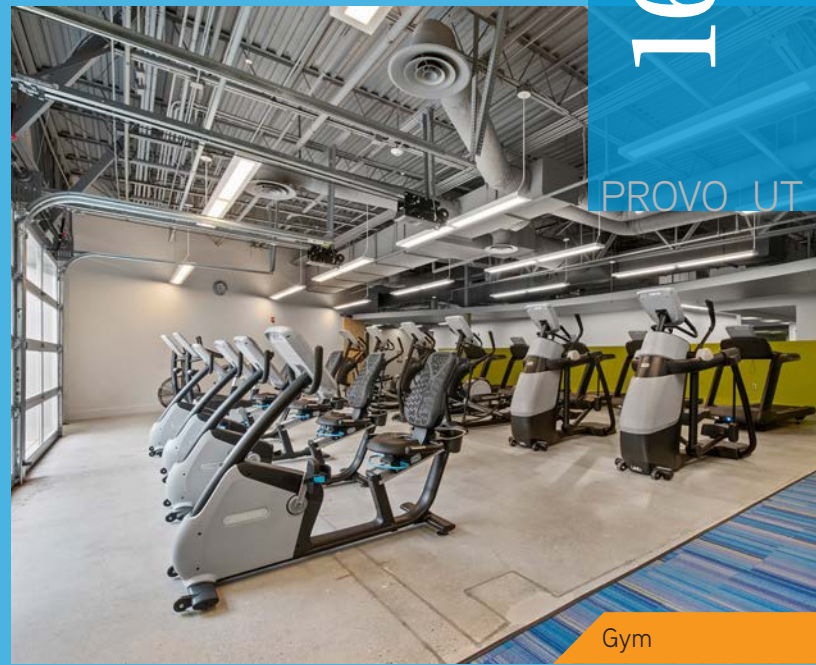

Gym



Shuttle Fleet



Building 7



- Josh Martin**
+1 801 830 2004
josh.martin@colliers.com
- Dan Donaldson**
+1 801 836 3600
dan.donaldson@colliers.com
- Brandon Huntsman**
+1 801 830 9232
brandon.huntsman@colliers.com
- Brandon Fugal**
+1 801 947 8300
brandon.fugal@colliers.com



Colliers International
2100 Pleasant Grove Blvd. | Suite 200
Pleasant Grove, UT 84062
P: +1 801 610 1300

www.colliers.com/utah

This document has been prepared by Colliers International for advertising and general information only. Colliers International makes no guarantees, representations or warranties of any kind, expressed or implied, regarding the information including, but not limited to, warranties of content, accuracy and reliability. Any interested party should undertake their own inquiries as to the accuracy of the information. Colliers International excludes unequivocally all inferred or implied terms, conditions and warranties arising out of this document and excludes all liability for loss and damages arising there from. This publication is the copyrighted property of Colliers International and/or its licensor(s). ©2019. All rights reserved.

Legend

- Shuttle Route
- Shuttle Stop



Shuttle Fleet

EXIT 263
TIMPANOGOS TECH CENTER